

DOUBL - MAT®

by LoadhandLer
Products



Call for assistance:
800-580-0791

DOUBL-MAT® FITS ALL FULL-SIZE TRUCKS & TRIMS TO FIT ALL MID-SIZE OR COMPACT TRUCKS

Dimensions: 4' X 8', 1/4" thick
Weight: 32 lbs.

The **Doubl-Mat®** is the number one solution to bed lining and the only reversible bed-mat on the market. Loadhandler's **Doubl-Mat®** combines a ribbed rubber surface to reduce load shifting with a high density **polyethelyne (HDPE)** surface for easier loading and unloading. Unlike rubber bed mats that must be removed when loading and unloading heavy cargo, the **Doubl-Mat® HDPE surface** allows you to slide your load, providing **crucial bed protection** when damage is most likely to occur.

Important:

If your pickup bed is rusty, or has a non-slip spray-in liner, you must have the Doubl-Mt (or similar slip-liner) in order to use the Loadhandler®.

If your pickup bed is in good shape or you have a plastic liner, you do not need the Doubl-Mat® in order to use the Ladhandler®.

Benefits of the Doubl-Mat®

- The rubber side provides a non-slip surface to stabilize cargo.
- The HDPE side provides a low friction surface that reduces the effort required to load or unload cargo.
- The Doubl-Mat® is ideal for use with all LOADHANDLER® pick-up truck unloaders. The Doubl-Mat® HDPE surface reduces the LOADHANDLER® crank force and is ideal for trucks with damaged beds or loads over 1200 lbs.

IMPORTANT NOTICE

IF YOUR LOAD JUST WON'T MOVE....**STOP!!!**

CHECK THE INSTALLATION CAREFULLY AND MAKE SURE YOU HAVE FOLLOWED THE INSTRUCTIONS PROPERLY. IF THE INSTALLATION IS CORRECT CHECK THE FOLLOWING:

1. IS THE LOAD GRASS CLIPPINGS, COMPOST OR TURF WHICH HAS BEEN LEFT IN THE TRUCK FOR MORE THAN A FEW HOURS? IF THE ANSWER IS "YES", YOU HAVE A **"LOCKED LOAD"!**
2. IS THE LOAD SCRAP ROOFING SHINGLES, FLOOR TILES OR SIMILAR? IF THE ANSWER IS "YES", YOU HAVE A **"LOCKED LOAD"!**
3. DOES THE LOAD "CAKE" EASILY, (CAN YOU MAKE A "SNOWBALL")?

IN CASE 1, 2 OR 3, THE LOAD HAS LOCKED ITSELF IN FRONT OF THE WHEEL WELLS. TO SOLVE THIS PROBLEM, CLEAR THE AREA ALONG EACH SIDE FROM THE WHEEL WELLS TO THE FRONT OF YOUR TRUCK. THIS SHOULD UNLOCK THE LOAD AND ALLOW YOU TO CRANK THE LOAD OUT.

4. WAS YOUR BEDLINER SPRAYED IN?
5. IS YOUR BEDLINER THE "NO SLIP" OR "NO SLIDE" TYPE?
6. DO YOU HAVE A RUBBER BED MAT STILL IN PLACE?
7. IS YOUR BED BARE METAL WHICH HAS RUSTED?

IN CASE 4 THROUGH 7, THE FRICTION UNDER THE DRAGSHEET IS TOO HIGH. UNLOAD ENOUGH WEIGHT BY HAND UNTIL YOU CAN CRANK THE REST OF THE LOAD OFF. THEN CONSIDER PURCHASING THE **DOUBL-MAT** BY LOADHANDLER. THE DOUBL-MAT IS BOTH A "SLIP-LINER" AND PROTECTIVE NON-SLIP (REVERSIBLE) MAT, 4' X8'.
**TO SPEAK WITH A LOADHANDLER PRODUCT SPECIALIST
CALL 1-800-580-0791**

INSTRUCTIONS

Check Parts List

- | | |
|------------------------------|---------------------------|
| 1 Main Roller with Dragsheet | 4 Shaft Collars |
| 2 Bearing Brackets | 2 Rear Brackets |
| 1 Crank Bar | 1 Handle Assembly |
| 1 Bag Fasteners | 2 Plastic End Caps |
| 2 Bolts 3/8" x 1 1/2" | 4 Round Head Screws #8 1" |
| 4 Washers 3/8" | 4 Square Nuts #8 |
| 2 Nuts 3/8" | |

MAIN ASSEMBLY

1. Remove the *Plastic End Caps* from each end of the *Roller*.
2. Slide one *Shaft Collar* onto each end of the *Roller*.
3. Slide a *Bearing Bracket* onto each end of the *Roller*. (Make sure the long leg of the *Bearing Bracket* is toward the front of the truck as shown).
4. Slide a second *Shaft Collar* on each end of the *Roller* and leave loose. (Insert the *Shaft Collar Screws and Nuts* but do not tighten them yet.)
5. Re-cap each end of the *Roller* with the *Plastic End Caps*.
6. Slide the *Rear Brackets* onto the *Bearing Brackets* as shown and loosely attach them with the *Bolts, Washers and Nuts* as shown.

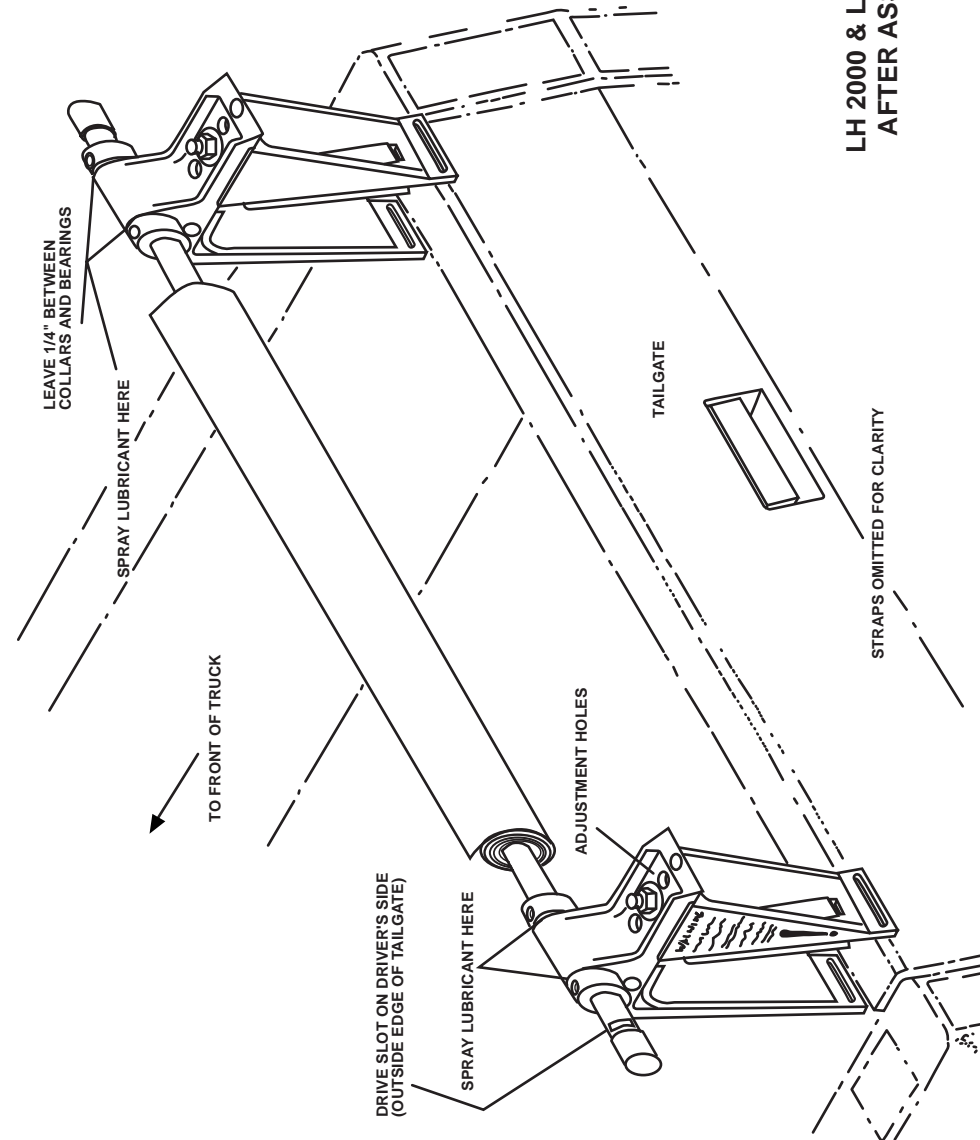

- It is much easier to clean out any residue from the truck if you remove the unit from the tailgate first.
- Always wash the dragsheet off with a hose at the end of the day. This will prevent sticky build up and keep the dragsheet slick.
- **DON'T FORGET THE CRANK HANDLE.** Always keep it in the cab. If you leave it on the truck bed, or on the ground, it can get covered by loose material or long grass.

If you are moving loads which "lock up" like scrap roof shingles, do not allow any of the load in front of the wheel wells. This will lock the whole load.

Do not allow grass clippings or other organic materials to stay in your truck for more than 24 hours. They may "knit" together and be difficult to get it out.

**FOR TECHNICAL ASSISTANCE
CALL 1-800-580-0791**

PASSENGER'S SIDE

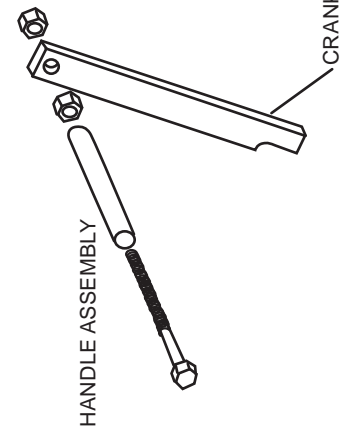
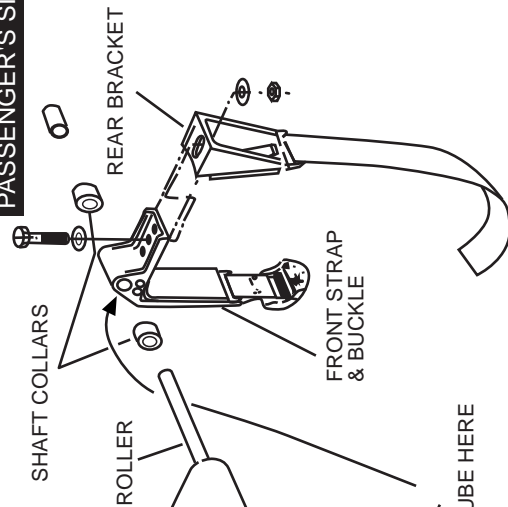

TO FRONT OF TRUCK

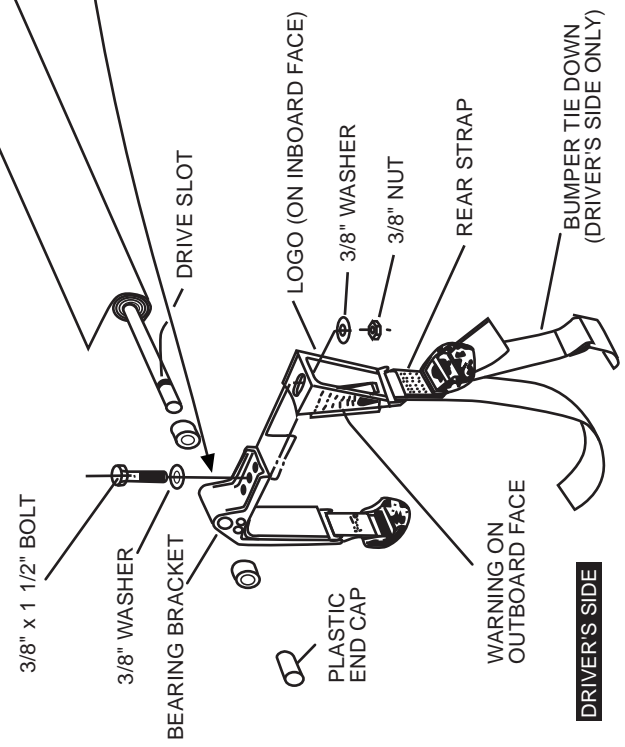

DRIVER'S SIDE

OPTIONAL DOUBL-MAT™

If you are hauling loads in excess of 1200 lbs
AND you do not have a plastic bed liner
AND your bed is rusty and/or damaged
AND you want to make it easier to unload

THEN

USE the optional Doubl-Mat™ Liner available from
your local Loadhandler® Retailer.

INSTALLATION

1. Hold the *Loadhandler*® so the Drive Slot in the Roller is on the Driver's side of the truck and **outside the edge of the tailgate.**
2. Place the *Loadhandler*® on the tailgate so that the tailgate is between the *rubber pads* on the *brackets*.
3. Slide the driver's side *Bearing Bracket* along the *Roller* until it is just clear of the wall of the truck. Slide the passenger's side *Bearing Bracket* along the *Roller* until it is stopped either by the *End Cap* or by the wall of the truck. Position the shaft collars to within 1/4" of the *bearing brackets* and tighten the shaft collar screws.
4. Slide the *Rear Bracket* towards the tailgate until the tailgate is snug between the *Bearing Bracket* and the *Rear Bracket*. Then tighten the nuts and bolts.
5. Insert the handle and swing it through its full circle to make sure it clears the truck. If necessary, loosen the *Shaft Collars* and slide the *Roller* further towards the driver's side until the handle clears, then re-tighten the *Shaft Collars*. (Refer to Item#10)
6. Gently lower the tailgate and SPRAY LUBRICATE the *Roller* where it passes through each bearing.

- Always wash down the truck bed and the dragsheet between loads. ***Grit accumulating on the dragsheet could more than double the effort needed to unload.***
- The cleaner the bed, the dragsheet, and the bearing surfaces, the easier it is to unload! (Little sharp stones sticking up from between the grooves in a bed liner can slit the dragsheet during the unload, and dirt build-up on the bearing surfaces makes it harder to crank.)
- When moving stone or gravel, try to keep the load on the centerline of the truck as much as possible. If too much of the load is against the walls of the truck, the dragsheet will tend to bunch and even fold over at the end of the unload. This won't bother the dragsheet too much, but it will result in a little more residue being left on the truck for you to sweep out.
- Sometimes the edge of the dragsheet may fray a little. Cut off the strands and carefully melt the edge with a cigarette lighter or soldering iron.
- Longitudinal slits in the dragsheet can be repaired. Just wash the dragsheet and let it dry...then repair with the best cloth duct tape.
- Always face away from the cab and use both hands on the crank handle.

DON'T STEP ON IT!

Never use any part of the LOADHANDLER® as a step to climb into or out of the pick-up - it may damage you, your truck or your LOADHANDLER®.

DON'T OVER LOAD IT!

Check your maximum allowable Gross Vehicle Rate or (GVWR). You will usually find it on the same sticker or plate as your recommended tire pressures. Look on your door posts, the edge of both doors, or on the inside of your glove compartment door. Always weigh your vehicle after loading to make sure you are not exceeding your allowable Gross Vehicle Weight.

USING THE LOADHANDLER®

- Never overload your truck. It is illegal and may cause severe damage to your vehicle and your LOADHANDLER®.
- Take care of your LOADHANDLER®. It will save you a lot of work.
- If the handle is hard to crank, you can lubricate the bearing with a silicone spray (or WD-40) where the bar passes through the bearing. If you lubricate the bearing, periodically check to ensure that it remains clean.

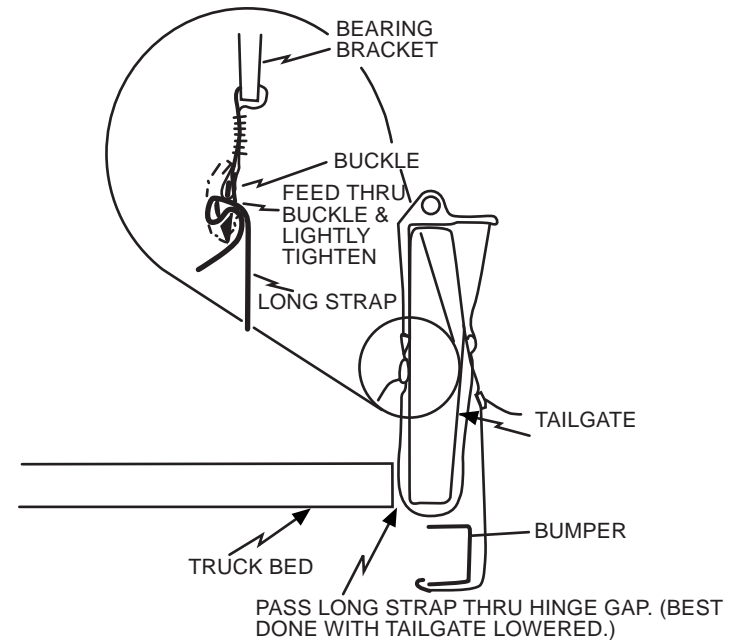

7. Feed the rear strap through the hinge gap between the tailgate and the truck and attach it to the front strap buckle as shown. Do not overtighten the strap.

Do this on both the Driver's side and the Passenger's side.
8. Loosen the *Bumper Tie Down Strap*, hook the flat hook onto the bottom of the truck bumper and pull tight. (Bumper Tie Down is utilized only when unloading. It holds tailgate down.)
9. Check to see that the *Drive Slot* is outside the edge of the tailgate.
10. If the *Dragsheet* is not centered across the truck, unwind it from the *Roller* and center it as required.
11. If you have an ordinary rubber bed mat, remove it before using your Loadhandler®.

TO LOAD

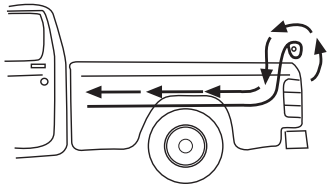

Untie Travel Straps.

Pull Dragsheet from Roller and lay on Bed Floor.

Always leave 3-4 wraps on the roller.

Load truck.

TO UNLOAD

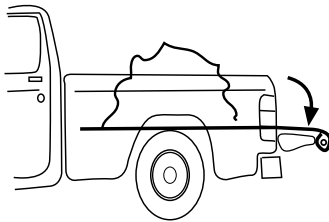

Open tailgate and spray lubricate the Bearings.

Re-tighten bumper strap.

Insert Crank Handle into Drive Slot on Roller.

Start cranking clockwise to roll up Dragsheet and unload Truck. (If handle is too close to the truck, readjust roller position until handle just clears the truck.)

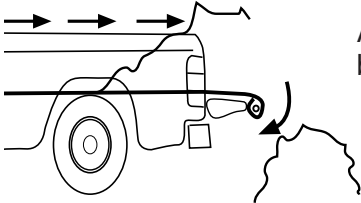

Always clean Bed of all materials before next load.

TO REMOVE LH2000

Loosen the two long straps and unhook the bumper strap.

Remove LOADHANDLER[®].

TO STOP ROLLER TURNING WHILE DRIVING WITH A HIGH LOAD

1. Press the two Velcro straps together to make one long strap.
2. Feed one end of this long strap through the drive slot.
3. Wrap the strap around the bearing bracket projecting from the rear of the tailgate.
4. Pull the strap and tight press the ends of the strap together to secure them in place.

This will keep the roller from turning while you are driving with a high load and stop the drag sheet from billowing behind the truck.

It is also a good place to keep the straps when you are loaded. You'll know where they are!

IF YOUR LOAD DOESN'T MOVE, STOP!

Check to see if the load is "LOCKED" around the wheel wells (see note on page 1). Call a product specialist at (800) 580-0791 for assistance if desired.

12-MONTH LIMITED WARRANTY

LOADHANDLER PRODUCTS CORPORATION warrants to the original retail purchaser that should this product or any part thereof, under normal use and conditions, be proven defective in material or workmanship within 12 months from date of original purchase, such defect(s) will be replaced.

To obtain the replacement within the terms of this warranty, return the item (shipping prepaid) to LOADHANDLER PRODUCTS CORPORATION, 342 N. FOURTH ST., LIBERTYVILLE, IL 60048 together with proof of warranty coverage (e.g. dated bill of sale) and a new part(s) will be shipped to you. **LOADHANDLER PRODUCTS CORPORATION will pay the packaging, shipping and handling cost** to ship the replacement part(s) to you.

The warranty does not apply to any product or part thereof which in the opinion of the Company has been damaged through alteration, improper installation, mishandling, misuse (including overloading), neglect or accident. THE EXTENT OF THE COMPANY'S LIABILITY UNDER THIS WARRANTY IS LIMITED TO THE REPLACEMENT PROVIDED ABOVE AND, IN NO EVENT, SHALL THE COMPANY'S LIABILITY EXCEED THE PURCHASE PRICE PAID BY THE PURCHASER FOR THE PRODUCT.

This warranty is in lieu of all other expressed warranties or liabilities. ANY IMPLIED WARRANTIES, INCLUDING ANY IMPLIED WARRANTY OF MERCHANT ABILITY, SHALL BE LIMITED TO THE DURATION OF THIS WRITTEN WARRANTY, ANY ABILITY FOR BREACH OF ANY WARRANTY HEREUNDER INCLUDING ANY IMPLIED WARRANTY OF MERCHANT ABILITY MUST BE BROUGHT WITHIN A PERIOD OF 12 MONTHS FROM DATE OF ORIGINAL PURCHASE. IN NO CASE SHALL THE COMPANY BE LIABLE FOR ANY CONSEQUENTIAL OR INCIDENTAL DAMAGES FOR BREACH OF THIS OR ANY OTHER WARRANTY, EXPRESSED OR IMPLIED, WHATSOEVER.

Some states do not allow limitations on how long an implied warranty lasts or the exclusion or limitation of incidental or consequential damage so the above limitations or exclusions may not apply to you. This warranty gives you specific legal rights and you may also have other rights that vary from state to state.

Model Number _____ Date Purchased _____ Name of Retailer _____



WARRANTY CARD

**IMPORTANT - TO RECORD YOUR WARRANTY,
FILL OUT THIS CARD AND RETURN IT IMMEDIATELY**

Model of Loadhandler Product: LH2000 LH2000M LH3000 LH3000M

Date Purchased _____ Did you purchase: Direct (800) From a retail store

Website Catalog Other _____

Name of Retailer _____ Location of Retailer _____

Name _____

Address _____

City _____ State _____ Zip _____

Make & Model of Truck _____ Telephone # _____

Did you learn of the Loadhandler through: TV Media Magazine-Type _____

Referral Retail Store Other _____

Comments: _____

You can mail to LOADHANDLER or fax to 847-932-4044



LOADHANDLER PRODUCTS CORPORATION

342 N. FOURTH ST., LIBERTYVILLE IL 60048

Phone: (800) 580-0791 / (847) 362-1031 FAX: (847) 932-4044

Website: www.loadhandler.com

LOADHANDLER® MODELS LH2000(full-size) & LH2000M(mid-size) INSTRUCTION MANUAL

It is highly recommended that the Loadhandler® be removed from your vehicle when not in use to avoid any dulling of the finish caused by dust or dirt. Do not let dust, dirt, unloaded materials, etc., accumulate under the protective rubber pads on the brackets. Check brackets between loads.



PLACE
STAMP
HERE



SEND TO:

**LOADHANDLER PRODUCTS CORPORATION
342 N. FOURTH ST.
LIBERTYVILLE IL 60048**

PLEASE READ ALL DOCUMENTS IN THIS PACKAGE!

Although the Loadhandler® is a simple tool, unloading heavy or bulky loads from your truck can create unusual conditions. Please read all documents to ensure the proper assembly and operation of your Loadhandler®.

NEVER OVERLOAD YOUR VEHICLE. IT IS DANGEROUS!

U.S. Patent Number 5,340,266
Other U.S. and Foreign Patents Pending

